

**\*Proposed LCRA  
Production Well Coordinates**

Well ID	Latitude	Longitude
1	30.202285	-97.207107
2	30.196312	-97.205782
3	30.191995	-97.210665
4	30.187590	-97.215441
5	30.183820	-97.219671
6	30.180035	-97.223745
7	30.176107	-97.228192
8	30.172072	-97.232585

\*Wells will be located within 200 feet of the proposed well location coordinate. Exact location of each well will be determined after field survey and final engineering design. Wells will not be located closer than 1,000 feet from the southeast property boundary.

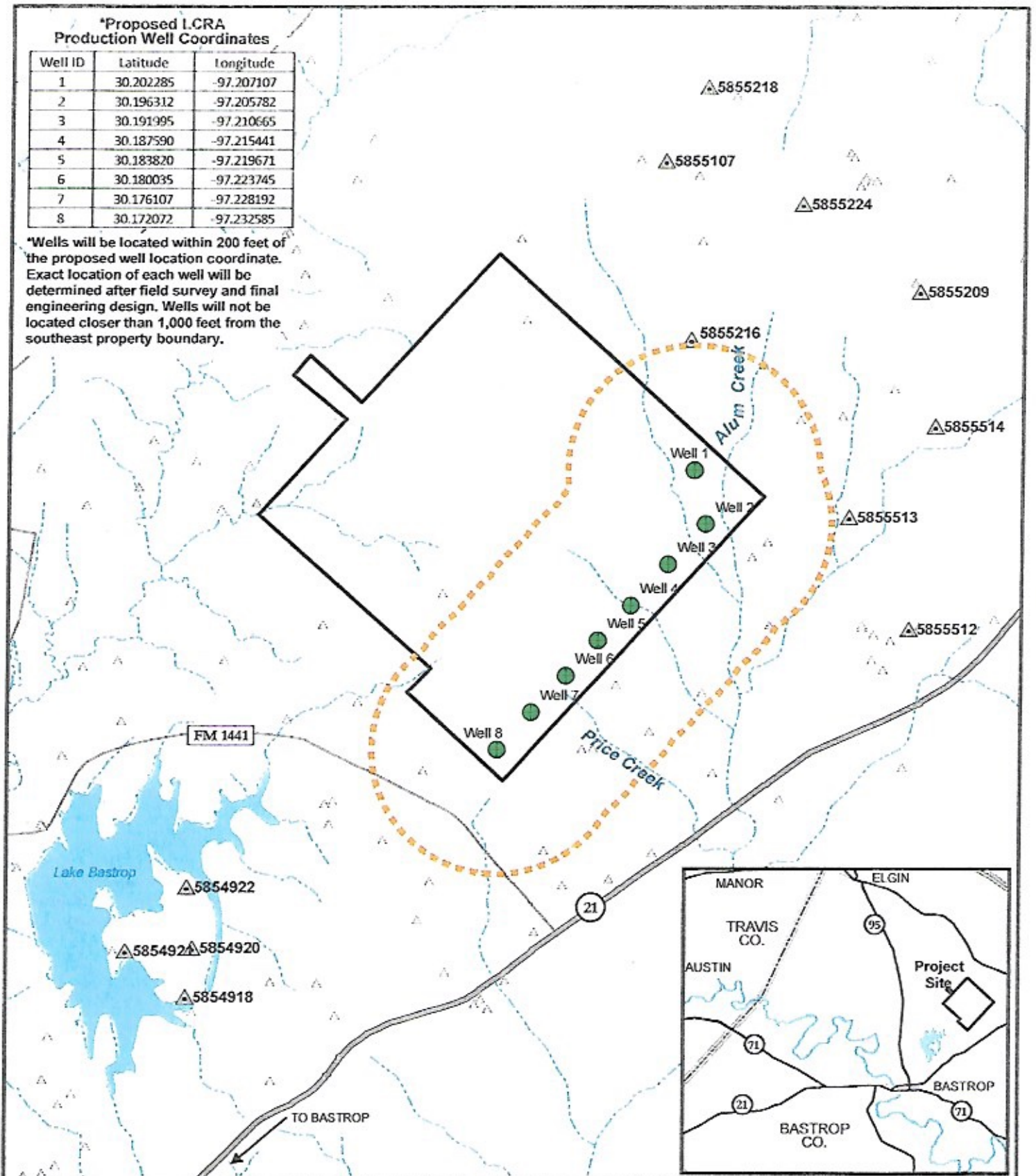

- Legend**
- Proposed LCRA production well areas
  - 5,000-foot buffer
  - Griffith League Ranch property boundary
  - ▲ Permitted wells as of 2017-12-29
  - △ Exempt wells as of 2017-8-10

**Attachment C  
LCRA Griffith League Ranch  
Proposed Well Locations  
February 1, 2018**